

# ProLine FreeStand Set-Up Sheet



## PROLINE FREESTAND FULLY ASSEMBLED

NOTE: Camera and tripod not provided.

**STEP 1 - ATTACH STAND MOUNT  
TO BRACKET** (may be already attached)  
Screw stand mount into bottom of bracket.



## STEP 2 - ATTACH BRACKET TO STAND

The ProLine FreeStand's patent pending mounting system allows the use of any size/weight camera. The FreeStand ships with 2 stands, one short and one tall. Use the short stand if the subject is in a low chair. For normal chair and standing subjects use the taller stand.



Tighten handle after  
bracket is set onto stand.

## STEP 3 - LCD INSTALL

Slide the LCD monitor onto the rail and  
tighten the thumbscrew.

The LCD can be adjusted fore/aft by loosening  
the thumbscrew. To remove the LCD unscrew  
the thumbscrew all the way and slide the LCD  
off the rail.

**Note: The thumbscrew has a stop to keep it  
from coming out all the way.**



## MIRROR ASSEMBLY/REMOVAL

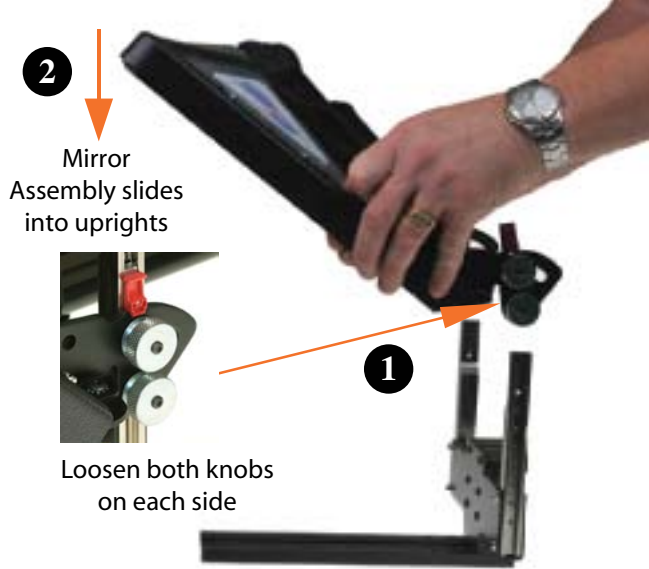

## MIRROR ASSEMBLY ATTACHMENT

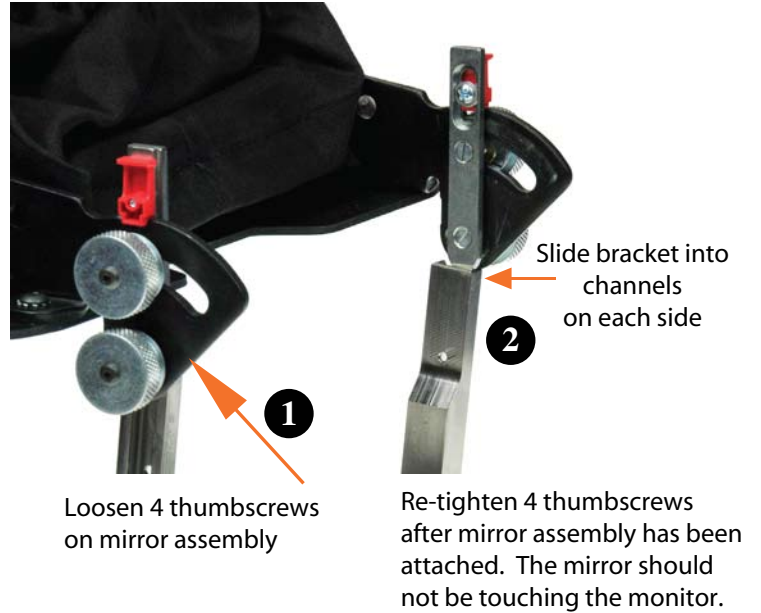

## ADJUSTING MIRROR ASSEMBLY

The ProLine FreeStand's patent pending mirror assembly offers both height and angle adjustment. The mirror assembly can also be folded flat for easy, safe transport. The mirror assembly offers an infinitely adjustable angle and locks at the closed and standard 45 degree positions. The mirror assembly can also be easily removed for more compact transport.

## OPENING MIRROR ASSEMBLY

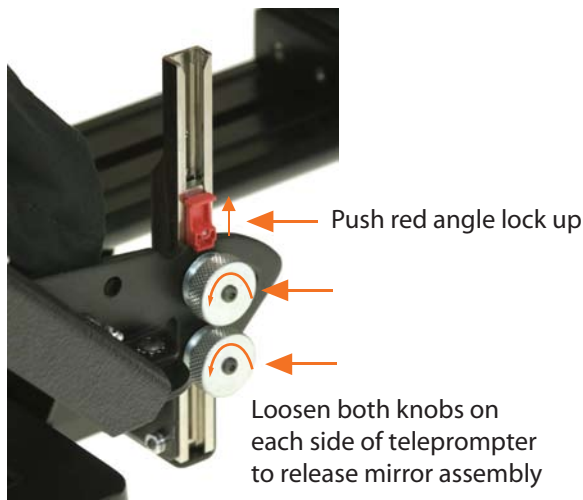

Press down red 45 degree angle locks into notch to lock mirror assembly in position.



Re-tighten knobs.

## STEP 4 - CAMERA/LCD POSITION ADJUSTMENT

The Proline FreeStand allows easy set-up and adjustment. The cloth lens shade wraps around the lens to keep light from entering from the rear. The LCD can be positioned fore/aft by loosening its thumbscrew. The LCD can be quickly removed for safe, compact transport. The mirror assembly can also be quickly and easily removed for safe and compact transport.



### ADJUSTING MIRROR HEIGHT

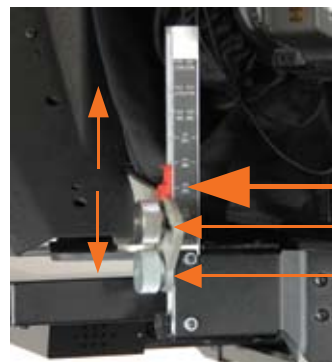

To use height scale position the top of the bracket to the point on the scale that corresponds to your camera's lens height. Measure the lens height from the bottom of the camera. Tighten both knobs on each side to lock mirror height in place

Camera should be positioned so that the lens is in the center of the hood opening. The lens should be within an inch of the beamsplitter. Attach the hood to the lens and tighten up the drawstring so there are no light leaks.

### ADJUSTING MIRROR ANGLE



To adjust mirror assembly to an angle other than 45 degrees do the following

1. Lift the angle lock on both sides.
2. *Slightly* loosen the four thumb screws,
3. Adjust angle and tighten knobs to lock

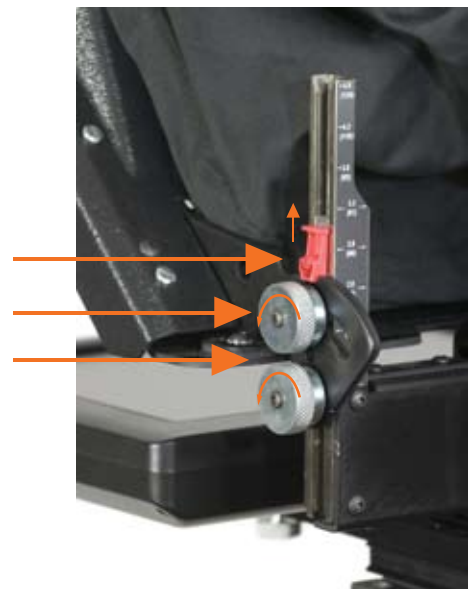

## GLASS REMOVAL PROCEDURE

It is not normally necessary to remove the beamsplitter glass from the hood. In certain cases such as breakage or cleaning requirements the glass must be removed. The glass is easily removed by unscrewing the four screws on each side of the mirror assembly. To replace the glass just reverse the procedure.

